

With beeper

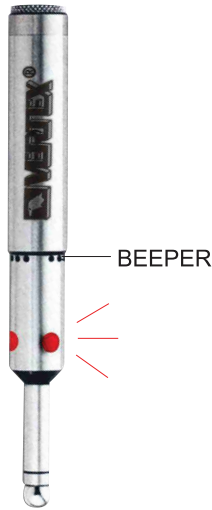

- No need to rotate while measuring.
- The red light was sealed with setting red-gel; it can concentrate the light and resist water.
- The sensor beeps while the red light is on.
- The sensor will beep when the user couldn't see the reverse side or get a clear sight.
- Example. If sensor's light is working, visually you couldn't see inside of the inner hole, while probing the user can be warned by the beeper.
- When probe the deep hole, you can't see the red light, but you can hear the sound from beeper.
- Accuracy: within 0.005mm.

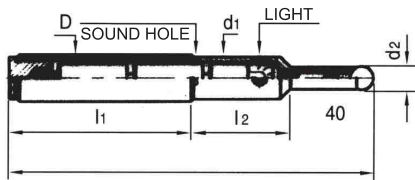

## OPTICAL TYPE WITH BEEPER

Unit:mm

ORDER NO.	D	d1	d2	L	l1	l2	BATTERY TYPE	WEIGHT (kg)	CODE NO.
VPS-20B	Ø20	18	10	160	79	41	UM-5#(SP) x1PCS/12V	0.4	3402-001
VPS-32B	Ø32	18	10	160	79	41		0.7	3402-002

Optical Type



VPS-20



VPS-32

- High sensitivity position sensor.
- Red pilot can be seen clearly.
- Whole travel of red pilot is sparking, detecting also can be done during turning while spindle stops.
- Location of end surface, outer circle dia., inner circle dia. of the work-piece for processing can be detected with full effect.
- Devised with safety line excess, ball supported by spring, so even line excess, it will be separated easily from the base shown as the fig.
- The precision will reach up to micrometer while the ball returns to center position.

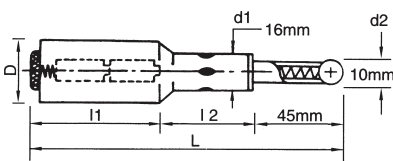
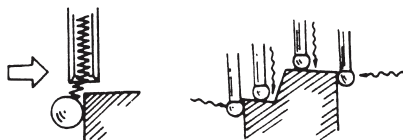

Fig.



## OPTICAL TYPE

Unit:mm

ORDER NO.	D	d1	d2	L	l1	l2	BATTERY TYPE	WEIGHT (kg)	CODE NO.
VPS-20	20	16	10	157	77	35	UM-5#(SP) x2P/R1./1.5V	0.4	3402-003
VPS-32	32	16	10	157	71	41		0.7	3402-004

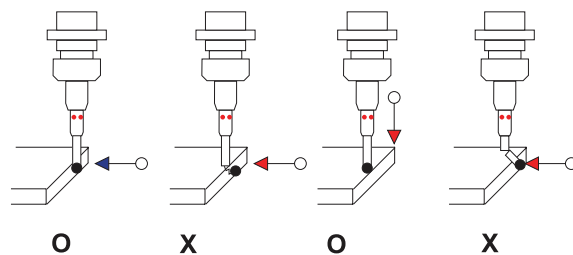



VPS-201

This series is a high precision setting device for positioning the accurate center between tool spindle of machine and reference surface of working at low-cost and saving time.

Accuracy : within 0.005 mm

Made of tool steel, hardened and ground.

Suitable rotation speed : VPS-201 450 to 600rpm.

VPS-401 600 to 1,000 rpm



CREAMIC TYPE VPS-201C

## MECHANICAL TYPE SIMPLE TYPE

ORDER NO.	VPS-201	VPS-201C
WEIGHT (KG)	0.03	0.06
CODE NO.	3402-005	3402-007

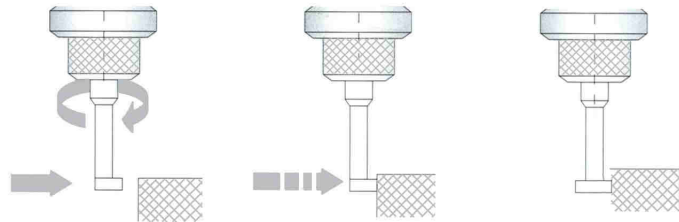
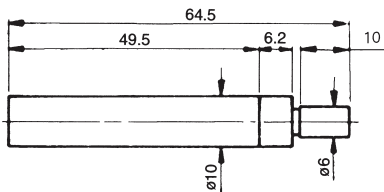

## Deluxe Type



VPS-401



VPS-401C

### FEATURES:

- Material: high-carbon steel.
- Accuracy: within 0.003mm
- Hardness: HRC 58° ± 1°
- R.P.M. Within 600-1000
- Suitable for milling machine.  
Drill machine and boring machine.

VPS-401 (2 PCS/SET)

VPS-402A(LONG) SINGLE

VPS-402B(SHORT) SINGLE

ORDER NO.	VPS-401	VPS-401C
PCS/SET	2PCS/SET	2PCS/SET
WEIGHT (KG)	0.26	0.26
CODE NO.	3402-006	3402-008

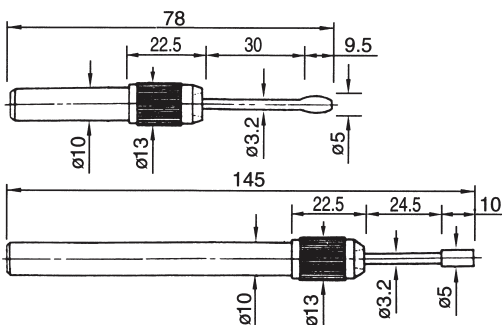

### EXAMPLES-APPLICATION

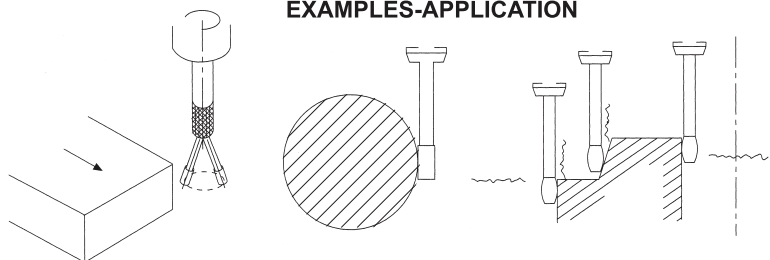

# Touch Point Sensor



## MECHANICAL TYPE



VPS-301



VPS-302



CERAMIC TYPE VPS-301C

- Accuracy of zero point to point is within 0.003mm
- R.P.M. within 450-600.
- Max. flange can be clear your sight sense.
- MIN.(4mm) can be test mini hole for your workpiece.

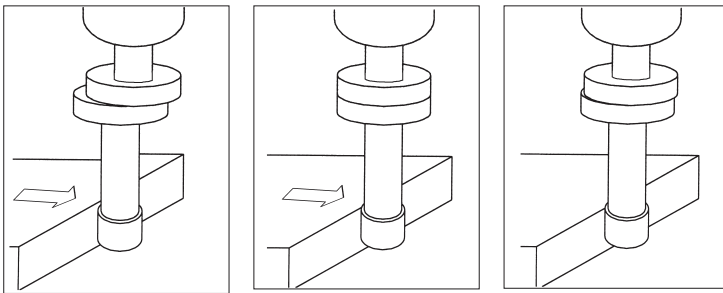
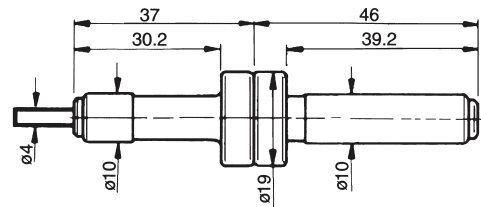
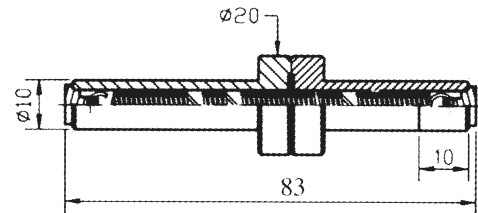

Spindle runs about 500rpm. move spindle closed to measuring surface.

When measuring probe touches workpiece, it looks in one part.

When the probe and shank are in alignment, probe will slide out of rotating center. Now, the center spindle is located 5mm away from measuring surface

ORDER NO.	MATERIAL	HARDNESS	WEIGHT (kg)	CODE NO.
VPS-301	ALLOY STEEL	HRC 56°	0.06	3402-100
VPS-302			0.05	3402-101
VPS-301S	STAINLESS	HRC 60°	0.06	3402-102
VPS-302S			0.06	3402-103
VPS-301C	CERAMIC	HRC 60°	0.06	3402-104

# Centering Indicator

ORDER NO.VCI-170 CODE NO.3402-130

- RPM Within 800.
- Use for Internal or External.
- Use for Vertical or Horizontal.
- While Spindle Rotates, With Stop bar for Fixing The Head The Centering Indicator Always faces the operator.



(WITH STOP BAR FOR FIXING THE HEAD)

Shank	ø10	m/m
Length	170	m/m
Internal	ø4~ø108	m/m
External	ø0~ø108	m/m
Min. Indicator	0.01	m/m
Indicator Range	0~6	m/m
Weight	0.8 kgs	

# Height Presetter



OPTICAL TYPE

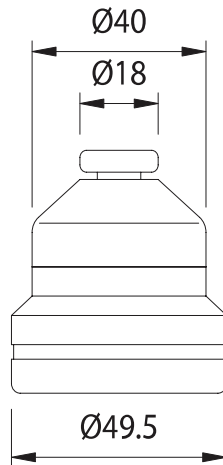

HP-50Z BATTERY  
LR4476AG13  
1SET/2PCS  
HP-50ZM  
LR44  
1SET/2PCS



- Height 50mm.
- With Magnetic base.
- The red lamp will be lighted up when touched.
- Accuracy 0.005mm.
- Combined vertical and horizontal in a unit.
- Weight:0.7kgs

	STANDARD TYPE	WITH MAGNETIC BASE
ORDER NO.	HP-50Z	HP-50ZM
CODE NO.	3403-001	3403-002

# Height Presetter (For Machining Center)

ORDER NO.HP-100 CODE NO.3403-010



- Locate the height presetter on a place suitable for a reference surface of work piece.
- Apply the cutter on the measuring surface and slowly lower the Z-axis. Then, cutter gets near to the measuring position.
- A distance from the reference surface to the tool tip can be measured easily and precisely so that this presetter is most suitable not only for machining centers but for NC lathes and NC milling machines.

\* Magnetic base function can be used in vertical position & horizontal position.  
\* HEIGHT:100mm±0.005

Height from reference surface	WEIGHT(kgs)
100mm	2.6



HP-50A



HP-50B

- Have the central measuring part of the zero setter presetter against a plain surface and aligned if with the outer reference surface. Turn the dial gauge for zero setting.
- Have the cutter touched against the z zero setter. Once the indicator position at zero, the distance between the tool tip to workpiece is 50mm.

ORDER NO.	H	STYLE	WEIGHT (kg)	CODE NO.
HP-50A	50mm	STANDARD TYPE	1.1	3403-020
HP-50B			1.7	3403-021
HP-50AM		WITH MAGNETIC BASE	1.2	3403-022
HP-50BM			1.7	3403-023

**Electronic Tool Length Setter**

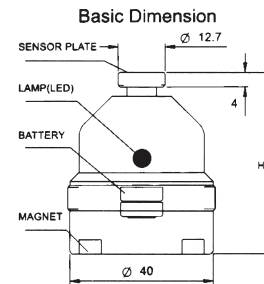

Stainless Steel Base With Magnet

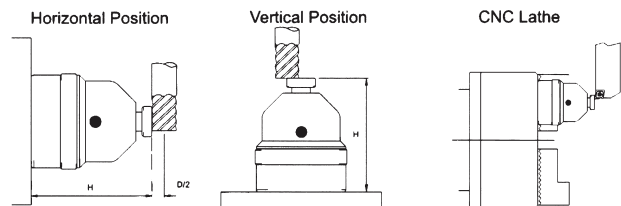

- **HIGH ACCURACY**
- **EASY OPERATION**

- Be sure to remove all chips and all from the sensor plate and the base of the HP-50E as well as from the workpiece and tool.
- To move the tool approaching the sensor plate slowly.
- When touching, the "LED" turns on immediately and "H" is just 50.00 mm.(or2")
- LED will not function if batteries are not set in correctly.
- Designed to be used on ferrous and non-ferrous materials.

ORDER NO.	H	STYLE	WEIGHT (kg)	CODE NO.
HP-50EM	50mm	WITH MAGNETIC BASE	0.3	3403-032
HP-100EM	100mm		1.2	3403-033

**Stainless Steel Base With Magnet**  
 TOOL PRE-SETTER FOR MACHINING CENTERS, CNC & STANDARD MILLING MACHINES AND CNC & STANDARD LATHES

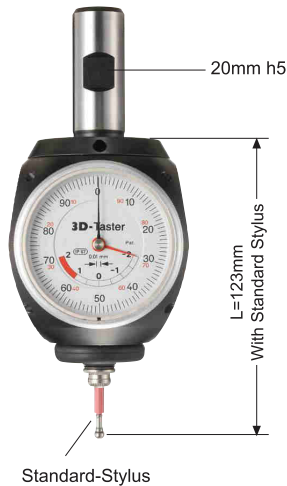

Find your exact zero points in all three axes in seconds with the new distance measuring scale (graduated and analogue).

- Black scale for radial deflection.
- Red scale for axial deflection
- Precise and effortless calipering of fixtures and workpiece edges.
- Setting of NC-programme zero points in seconds.
- Measuring of clamped workpieces.
- Generous overrun allowances prevent damage to Taster stylus.
- Easy and precise change of stylus.
- Weight: 0.93KGS

**STYLUS**

Change stylus in seconds  
No screws or special tools required  
Easy precision plug-in mechanism

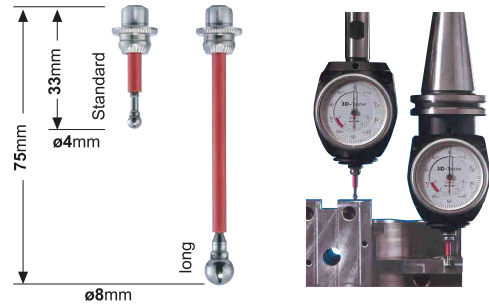
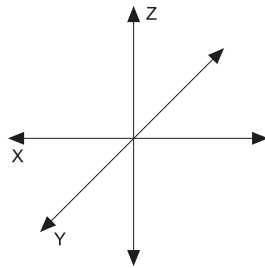

ORDER NO.	TYPE	WEIGHT	CODE NO.
V-3D-05	ø4x33 standard stylus	10g	3219-005
V-3D-06	ø8x75 long stylus	15g	3219-006

TYPE	ACCURACY
3D-Taster	0.01mm

**Integrated Type Keyless Drill Chucks**

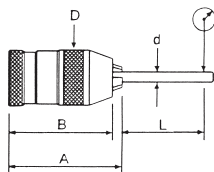

ORDER NO.	Clamping Capacity		Taper	OUTER Ø / mm	WEIGHT (kgs)	CODE NO.
	mm	inch				
INT-8-CAT30	0.5-8	1/64"-1/8"	CAT30	Ø35	0.8	3301-073
INT-13-CAT30	0.5-13	1/64"-1/2"				
INT-8-CAT40	0.5-8	1/64"-1/8"	CAT40	Ø35	1.32	3301-075
INT-13-CAT40	0.5-13	1/64"-1/2"				
INT-16-CAT40	3-16	1/8"-5/8"				
INT-13-CAT50	0.5-13	1/64"-1/2"	CAT50	Ø51.5	3.95	3301-078
INT-16-CAT50	3-16	1/8"-5/8"				

**Integrated Type Keyless Drill Chucks**

**RL type keyless drill chuck with BT SHANK**



- RL type drill has reinforce torque design to increase more clamping capacity.
- Right turn and left turn allowable.
- No sudden drop when stop or suddenly shift to different direction.
- Highest speed 6000rpm.
- Shorten the shank length which is stronger than traditional design improves the total rigidity.

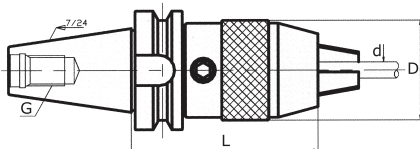

ORDER NO.	Clamping Capacity mm / d	L	D	G	CODE NO.
BT40-VRL13	0.5-13	95	50	M16	3301-090
BT40-VRL16	3-16	113	57	M16	3301-091
SK40-VRL13	0.5-13	85	50	M16	3301-092
SK40-VRL16	3-16	95	57	M16	3301-093